



Hillsborough County Florida

HILLSBOROUGH COUNTY PUBLIC WORKS ADMINISTRATION [Enter Originator] DEPARTMENT

CIP NO.	FISCAL YEAR	SHEET NO
12345678	00	1

CONTRACT PLANS COMPONENTS:
ROADWAY PLANS
SIGNING & PAVEMENT MARKING PLANS
SIGNALIZATION PLANS
UTILITY RELOCATION PLANS

CONTRACT PLANS PROJECT NAME FROM ROAD 1 TO ROAD 2 CIP # 12345678

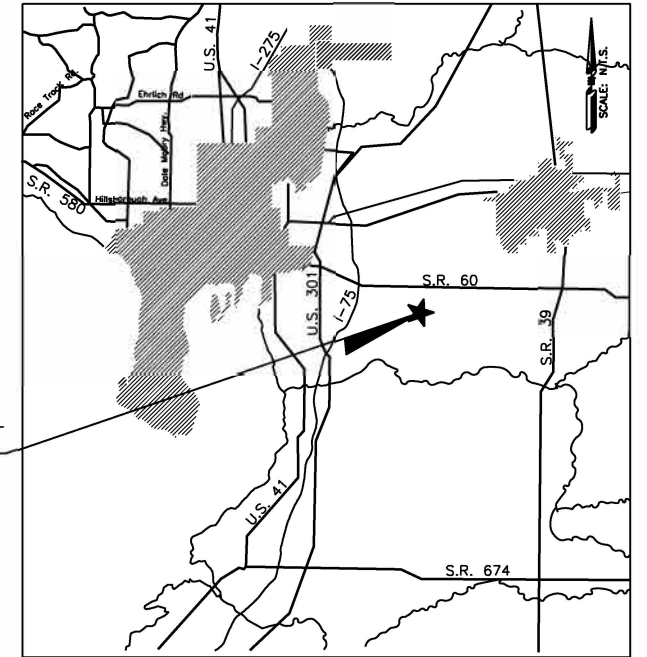

INDEX OF ROADWAY PLANS

SHEET NO.	SHEET DESCRIPTION
1	KEY SHEET
1A	REVISIONS
2	SUMMARY OF PAY ITEMS
3	DRAINAGE MAP
4	TYPICAL SECTION
5 - 8	SUMMARY OF DRAINAGE STRUCTURES
9	PROJECT LAYOUT
10	PROJECT CONTROL
11	ROADWAY GENERAL NOTES
12 - 15	PAVEMENT TABLE SHEET
16	CONSTRUCTION DETAIL
17	ROADWAY DETAIL
18 - 22	DRAINAGE STRUCTURES
23	ROADWAY DETAIL SHEET
24	ROADWAY SOILS SURVEY
25 - 34	CROSS SECTIONS
35	STORMWATER POLLUTION PREVENTION PLAN
36 - 37	EROSION CONTROL PLAN
38	TRAFFIC CONTROL GENERAL NOTES
39 - 43	TRAFFIC CONTROL PLAN
44 - 48	UTILITY ADJUSTMENTS
SQ-1 - SQ-5	SUMMARY OF QUANTITIES
GCB-001	GREEN COLORED CONTRAST BLOCK
TAD-001	TRUCK APRON DETAIL

BEGIN PROJECT
Q CONST. ROAD 1
STA. 100+00.00
N 000000.00
E 000000.00

BEGIN PROJECT
Q CONST. ROAD 2
STA. 200+00.00
N 000000.00
E 000000.00

STA. 100+00.00
Q CONST. ROAD 1 =
STA. 200+00.00
Q CONST. ROAD 2
N 000000.00
E 000000.00

TO CITY
END PROJECT
Q CONST. ROAD 2
STA. 200+00.00
N 000000.00
E 000000.00

T##X
T##X
END PROJECT
Q CONST. ROAD 1
STA. 100+00.00
N 000000.00
E 000000.00

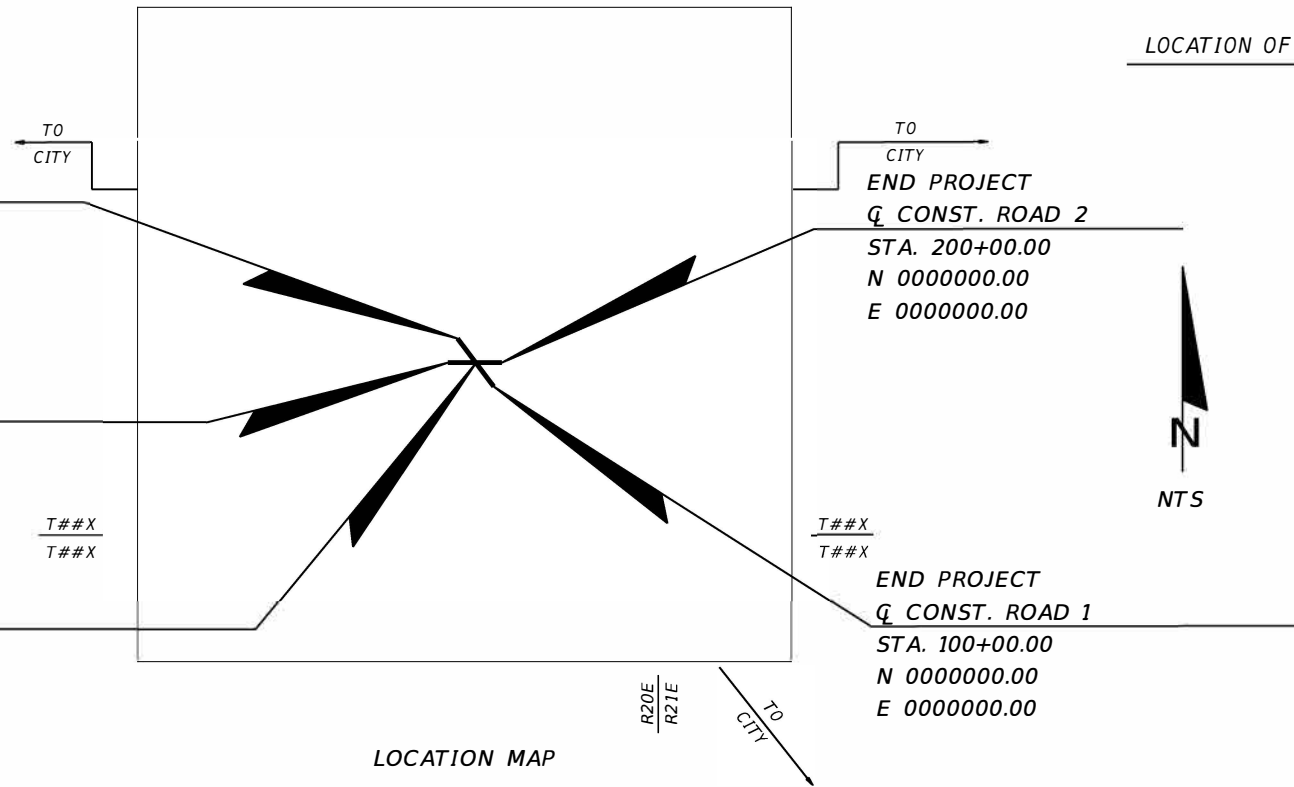

LOCATION MAP
SECTION # TOWNSHIP ##X, RANGE ##X

FOR COMPLETE LIST
SEE FDOT PLAN PART 3,
SEE CHAPTER 522.6

THE BOARD OF COUNTY COMMISSIONERS
FIRST1 LAST1 CHAIRMAN
FIRST2 LAST2 VICE-CHAIRMAN
FIRST3 LAST3 CHAPLAIN
FIRST4 LAST4 COMMISSIONER
FIRST5 LAST5 COMMISSIONER
FIRST6 LAST6 COMMISSIONER
FIRST7 LAST7 COMMISSIONER

PLANS PREPARED BY:
LUCAS SKYWALKER, P.E., NO. 00001
L. SKYWALKER COMPANY
601 E. KENNEDY BOULEVARD
TAMPA, FL 33602
(813) 307-4000

GOVERNING DESIGN STANDARDS:

Florida Department of Transportation, FY 20##-## Standard Plans for Road and Bridge Construction and applicable Interim Revisions (IRs).

Standard Plans for Road Construction and associated IRs are available at the following website: <http://www.fdot.gov/design/standardplans>

Hillsborough County Standard Details and General Notes are available at the following website: <https://www.hillsboroughcounty.org/en/government/county-projects/consultant-cip-project-resources/standard-details-and-project-plan-sheet-templates>

GOVERNING STANDARD SPECIFICATIONS:

Hillsborough County Public Works Standard Specifications for Construction OCTOBER 2021 and FDOT Standard Specifications for Roadway and Bridge Construction, Divisions II & III as directed under the Hillsborough County Standard Specifications for Construction.

REVISIONS		
DATE	BY	DESCRIPTION
##-##-##	XXX	ADDED REVISIONS SHEET 1A TO INDEX

LENGTH OF PROJECT		
DESCRIPTION	LIN. FT.	MILES
ROADWAY (ROAD 1)	0000.00	0.000
ROADWAY (ROAD 2)	0000.00	0.000
BRIDGES	0000.00	0.000
NET LENGTH OF PROJECT	0000.00	0.000
EXCEPTIONS	0000.00	0.000
GROSS LENGTH OF PROJECT	0000.00	0.000

ENGINEER OF RECORD: L. SKYWALKER, P.E.
P.E. NO.: 00001

KEY SHEET REVISIONS	
DATE	DESCRIPTION

NOTE: THE SCALE OF THESE PLANS MAY HAVE CHANGED DUE TO REPRODUCTION.

COUNTY C.I.P. PROJECT MANAGER _____